



SV17
EX

Mini-excavator



SV17Ex
Operating weight : 1925/1805 kg
Arm digging force : 755 kgf
Bucket digging force : 1550 kgf

*The SV17Ex creat
in the class of 1,5
new Semi-*



Mini-excavator



*es a new standard
00 kg-excavators :
ViO series.*



SV17
EX



Compactness

*The Semi-ViO series makes an impact!
For the first time, a 1-ton excavator combines compact dimensions with high performance levels.*

Design principles

- Compact dimensions :
 - width of the machine reduced to 980 mm (retracted undercarriage) ;
 - rear swing radius : 980 mm ;
 - front swing radius with boom swing : 1340 mm.
- Weight and dimensions allowing easy transport on a trailer or in an utility vehicle.

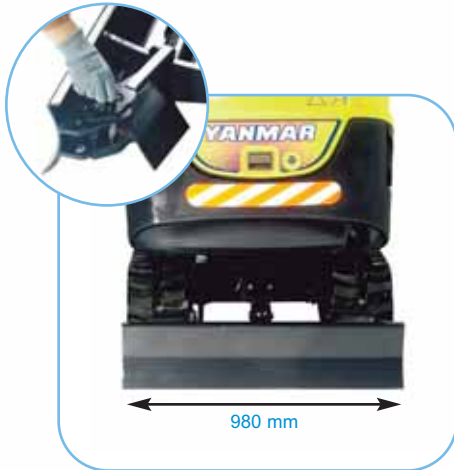

Extendable undercarriage of unique conception

- The hinged blade extensions are permanently fixed on the blade. No tools are necessary to change quickly the position.
- A switch selects the blade moving or the undercarriage extension : the blade lever selects the desired function.
- Reduced clearance between the sliding parts : no soil build-up during the extension of undercarriage.
- High reliability over a long-term period.
- The SV17Ex is extremely stable due to the use of an extended undercarriage and good weight distribution.

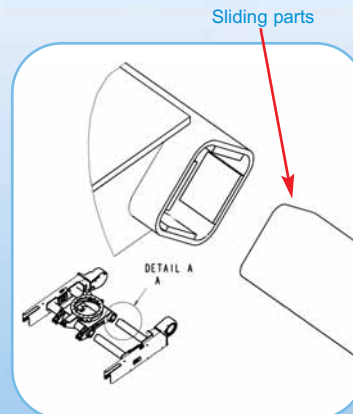

4 sliding parts at 45° for a better rigidity and less wear.

Advantages for the user

- Possibility to work in narrow areas, where a conventional machine of 1500 kg is not able to work.
- Maximum superb all-round visibility : safety and productivity for the operator.
- Particularly well-suited to work in urban areas : cable-laying, landscaping...
- Loading and easy transfer from one site to another : more productivity.



Switch for undercarriage extension

Mini-excavator



ies from Yanmar
n this weight class.
500 kg mini-excavator
pact dimensions,
els and great stability.

Comfort and safety

Spacious and ergonomic pilot system

- Perfect position of joysticks, armrests and travel levers with pedals.
- Separate pedals for using the auxiliary power take-off line and boom offset.
- Comfortable, multi-adjustable seat.
- Access possible from both sides on the canopy version.



**SV17
EX**

Spacious cabin

- Cabin with a lot of space for such a compact machine.
- Wide access to the operating position.
- Defroster, heater, ventilation, inside lighting, windscreen washer.



Maximum operator safety

- Canopy and cabin meet the requirements of the strictest safety standards :
 - ROPS (Roll Over Protective Structure) ;
 - FOPS 1 (Falling Object Protective Structure) ;
 - TOPS (Tip-Over Protective Structure).
- Large safety lever on access to control position : in the raised position it prevents all working movements and travel.
- The really designed boom enables perfect visibility to the bottom of the trench.



**AMMANN
YANMAR**

*ies from Yanmar
n this weight class.
500 kg mini-excavator
pact dimensions,
els and great stability.*



High performan

Hydraulic circuit Load-Sensing. Variable flow piston pump.

- Precise working movements.
- Simultaneous operations.
- Safety and productivity, particularly for operations requiring accuracy : grading.



Dual or single-action auxiliary circuit fitted to arm end.

**SV17
EX**

Reliability and a

Robust construction

- Machine constructed using modular assemblies : easy and reliable assembly of all components.
- Upper frame made from a single casting providing improved stability and greater durability.
- Rear and side bonnets in steel.
- Perfect protection on boom and blade cylinders.
- Integrated working lamp.



A new-generation Yanmar “TNV” (Totally New Value) engine

- Improvement and modernisation of TNE series, which is already well-known for its “clean and quiet” profile :
 - reduced emissions for an even cleaner engine ;
 - noise reduction for an even quieter engine ;
 - improved starting (warms up faster).
- The new TNV series exceeds the most stringent emissions standards.

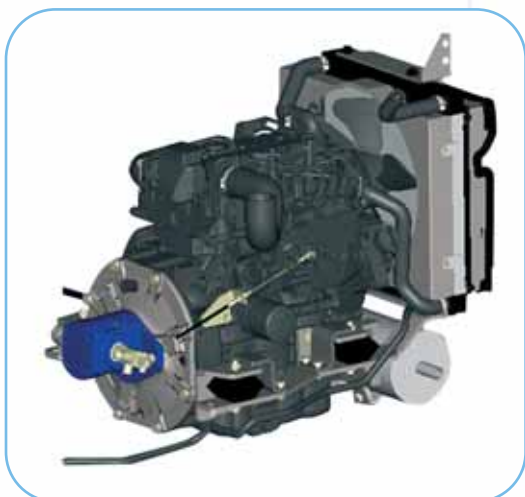

Successful combination between the engine and the hydraulic system

- Reduced fuel consumption.
- Increased productivity.
- Less exhaust fumes.

Excellent traction forces for an excavator in this weight class.

2nd speed command.

Tank refuelling



Accessibility

Easy access to all maintenance points : significant decrease in service times and operational costs

- Large rear bonnet : Direct access to fuel, air, hydraulic return filters and coolant expansion tank.
- Opening of the front seat plate : Immediate access to battery, alternator, starter motor, PTO selector valve and electrical components.
- Removing of the right hand side panel : Immediate access to fuel tank and radiators.
- Removing of the left hand side panel : Direct access to hydraulic pump and suction filter.
- Quick access to the control valve by removing the left side panel and the floor plate.



TECHNICAL SPECI

Engine

Yanmar Diesel 3 cylinders	3TNV70-VBVA
Rated output (DIN 6270B)	9.5 kw/ 12.9 HP/2100 rpm
Displacement	854 cm ³
Max. torque	51.4 N.m./1500 rpm

Load-Sensing hydraulic circuit

System capacity	24.5 l	Straight travelling	
Hydraulic tank capacity	16 l	Direct return to hydraulic tank	
Max. pressure	196 bar	Accumulator	
Variable flow piston pump	37.8 l/mn		

Performances

Travelling speed	2.0/3.5 km/h	Gradeability	30°
Swing speed	9.4 rpm	Shoe width	230 mm
Digging force (arm/bucket)	755/1550 kgf	Ground pressure	160 mm
Boom swing (L/R)	40°/80°	Blade (width x height)	980/1320 x 230 mm
Ground pressure*	0.32/0.30 kg/cm ²		* cabin/canopy



Miscellaneous

Fuel tank	24.5 l
Cooling system	2.9 l
Transport dimensions (L x w x h)	3660 x 980 x 2256 mm
Noise level LwA (2000/14/EC & 2005/88/EC)	93 dBA



Optional equipment

Special paint	Right hand side rear view mirror
Safety device for loading	Left hand side rear view mirror
Anti-theft device	Rear mounted mirror
2 additional working lights	Cup holder / bottle holder (Cab)

PTO	Theoretical data	
	Pressure	2100 rpm
	0 ~ 196 bar	37.8 ~ 17.5 l/mn
	0 ~ 196 bar	37.8 ~ 17.5 l/mn



- The output reduces as the pressure increases.





AMMANN-YANMAR SAS

25, rue de la Tambourine - F-52100 SAINT DIZIER

sales@ammann-yanmar.fr

www.ammann-yanmar.com

